

CITY OF NAPOLEON GENERAL PERMIT APPLICATION

THIS APPLICATION IS FOR RESIDENTAL CONSTRUCTION INCLUDING BUILDING, ELECTRICAL,
PLUMBING, MECHANICAL & REMODELING

7222
7-14-0501

DATE 8/15/14 JOB LOCATION 132 Sheffield Ave, Napoleon.
 OWNER TODD HERWAUDEZ TELEPHONE # 919-866-6577
 OWNER ADDRESS same
 CONTRACTOR N/A CELL PHONE # _____
 DESCRIPTION OF WORK TO BE PERFORMED Build a deck

ESTIMATED COMPLETION DATE 8/22/14 ESTIMATED COST \$3,000

Affected Floor Area (AFA): In existing structures, it is the area affected by the improvement, i.e. a new wall dividing a room (the AFA would be only the room and not all the rooms).

DESCRIPTION	FEE	TOTAL COST
BUILDING:		
<i>Decks</i>	\$25.00	\$ <u>25</u>
<i>Addition & Alterations</i> Square foot in (AFA) _____ x \$0.05 = \$ _____ + \$25.00 = \$ _____		
<i>Garage and Shed over 200 SF (Detached)</i>	\$25.00	\$
<i>Siding and/or Roofing</i>	\$25.00	\$
<i>Windows/Doors</i>	\$25.00	\$
ELECTRICAL:		
<i>Electrical</i> Circuits in (AFA) _____ x \$3.00/Circuit = \$ _____ + \$25.00 = \$ _____		
<i>Electrical Service Upgrade</i>	\$25.00	\$
MECHANICAL:		
<i>Water Heater</i>	\$25.00	\$
<i>Furnace and/or AC Replacement</i>	\$25.00	\$
PLUMBING:		
<i>Plumbing</i> Traps in (AFA) _____ x \$3.00/Trap = \$ _____ + \$25.00 = \$ _____		
TOTAL plus Ohio Board of Building Standards Fee 1%		\$ <u>.25</u>

TOTAL FEE: \$ 25.25

I FULLY UNDERSTAND THAT NO EXCAVATION, CONSTRUCTION OR STRUCTURAL ALTERATION, ELECTRICAL OR MECHANICAL INSTALLATION OR ALTERATION OF ANY BUILDING STRUCTURE, SIGN, OR PART THEREOF AND NO USE OF THE ABOVE SHALL BE UNDERTAKEN OR PERFORMED UNTIL THE PERMIT APPLIED FOR HEREIN HAS BEEN APPROVED AND ISSUED BY THE CITY OF NAPOLEON BUILDING/ZONING DEPARTMENT.

I hereby certify that I am the Owner of the named property, or that the proposed work is authorized by the Owner of record and that I have been authorized by the Owner to make this application as his/her authorized agent and I agree to conform to all applicable laws of the jurisdiction. In addition, if a permit for Work described in this application is issued, I certify that the code official or the code official's authorized representative shall have the authority to enter areas covered by such permit at any reasonable hour to enforce the provisions of the code(s) applicable to such permit.

I HEREBY ACKNOWLEDGE THAT I HAVE READ AND FULLY UNDERSTAND THE ABOVE LISTED INSTRUCTIONS.

SIGNATURE OF APPLICANT: _____ DATE: _____

PRINT NAME:

PERMIT # _____ BATCH # 30588 CHECK # CASH DATE 8-15-14

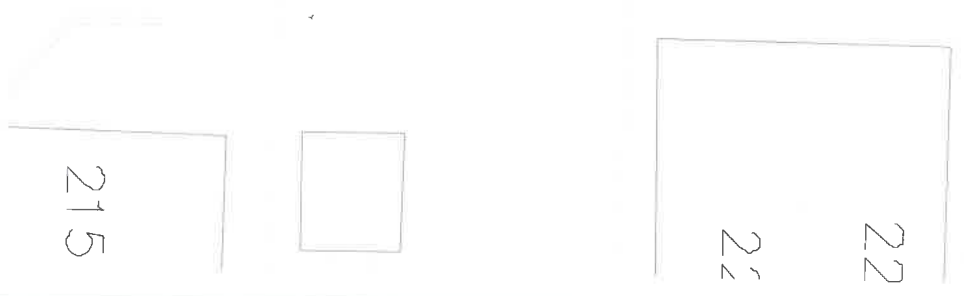
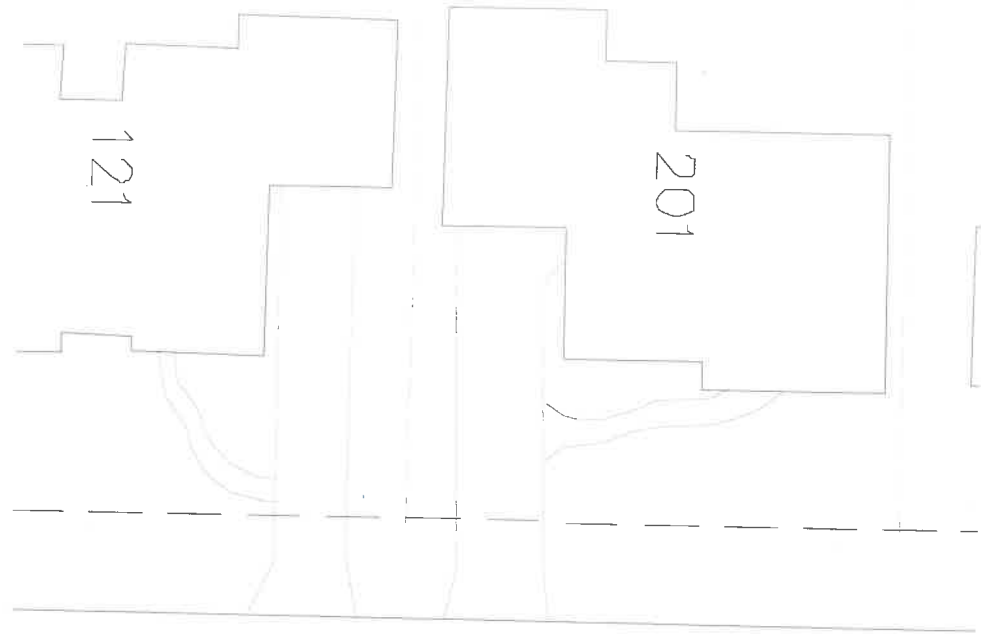

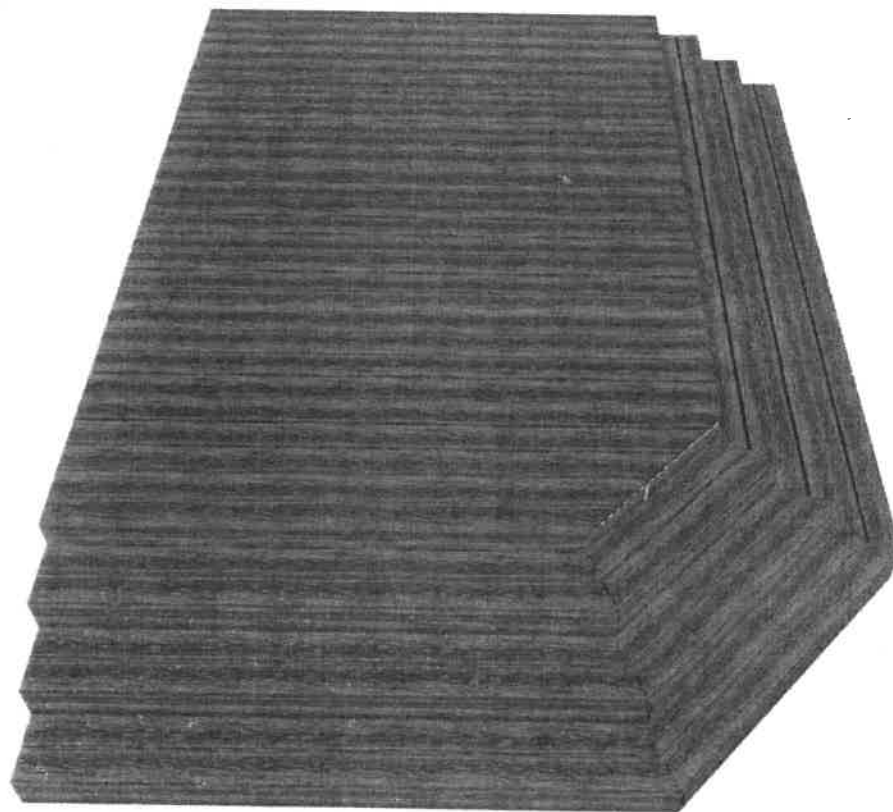

Illustration intended to show general deck size and shape. Some Options selected may not be shown for picture clarity.

Estimated Price:

\$2,592.12*

*Today's estimated price, future pricing may go up or down. Tax, labor, and delivery not included.

Base Price:

\$2,598.71**

**The base price includes: 40 PSF deck live load, AC2 5/4x6 deck boards in horizontal direction, AC2 4x4 framing posts, precast concrete (1 bag) footing, AC2 joists and beams with two feet cantilever, galvanized framing fasteners and joists hangers, and premium deck board screws.

Final design should be performed by a registered professional engineer to ensure all applicable building codes and regulations are met.

This is an estimate. It is only for general price information. This is not an offer and there can be no legally binding contract between the parties based on this estimate. The prices stated herein are subject to change depending upon the market conditions. The prices stated on this estimate are not firm for any time period unless specifically written otherwise on this form. The availability of materials is subject to inventory conditions. MENARDS IS NOT RESPONSIBLE FOR ANY LOSS INCURRED BY THE GUEST WHO RELIES ON PRICES SET FORTH HEREIN OR ON THE AVAILABILITY OF ANY MATERIALS STATED HEREIN. All information on this form, other than price, has been provided by the guest and Menards is not responsible for any errors in the information on this estimate, including but not limited to quantity, dimension and quality. Please examine this estimate carefully. MENARDS MAKES NO REPRESENTATIONS, ORAL, WRITTEN OR OTHERWISE THAT THE MATERIALS LISTED ARE SUITABLE FOR ANY PURPOSE BEING CONSIDERED BY THE GUEST. BECAUSE OF THE WIDE VARIATIONS IN CODES, THERE ARE NO REPRESENTATIONS THAT THE MATERIALS LISTED HEREIN MEET YOUR CODE REQUIREMENTS.

Beam Layout for Level 1

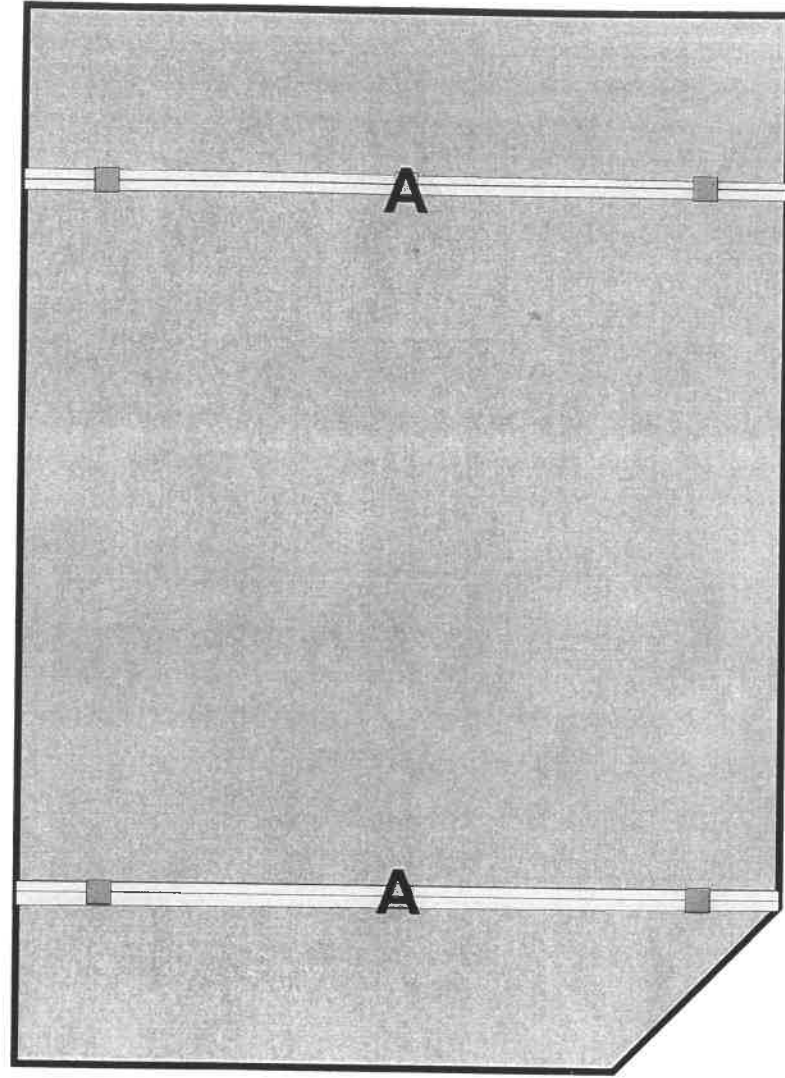

Mark	Length	Description
A	9' 3"	4-2X8 AC2

Level Information

Level 1 - 9' 3" Length X 12' 9" Width X 2' 0" Height, Standard Deck, 40 PSF Load Rating, Horizontal Decking Direction, 16" Joist Spacing

Framing Information

- 4X4 AC2 Framing Posts
- Post Support Pier Footing
- 2X8 AC2 Joists
- 2X8 AC2 Beams
- Solid Placement for Beam Positioning on Framing Posts
- Beam and Joist Cantilever - 2 Feet

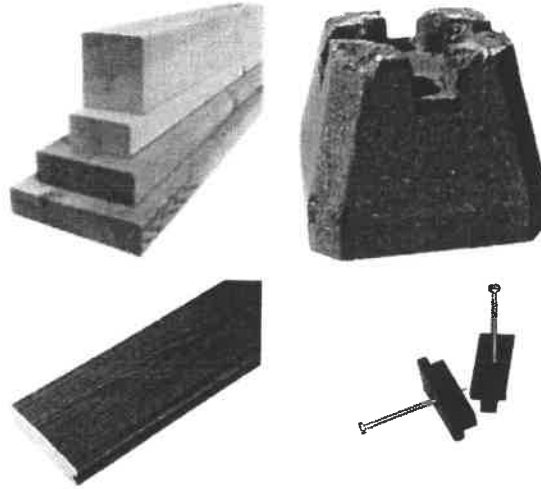

Deck Board Information

- Gray Rustic Solid Composite
- UltraDeck Fusion T-Clips w/Square Drive Screws
- Has Cladding

Railing Information

No Railing

Other Material Information

- Galvanized Joist Hangers
- Galvanized Framing Fasteners

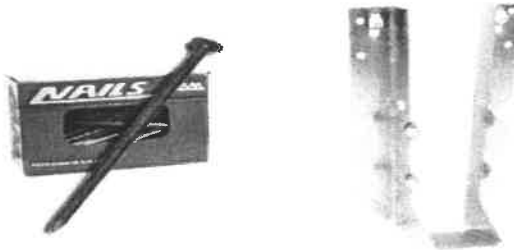

Estimated Price:

\$2,592.12*

*Today's estimated price, future pricing may go up or down. Tax, labor, and delivery not included.

Base Price:

\$2,598.71**

**The base price includes: 40 PSF deck live load, AC2 5/4x6 deck boards in horizontal direction, AC2 4x4 framing posts, precast concrete (1 bag) footing, AC2 joists and beams with two feet cantilever, galvanized framing fasteners and joists hangers, and premium deck board screws.

Final design should be performed by a registered professional engineer to ensure all applicable building codes and regulations are met.

Post and Beam Dimension Sheet for Level 1

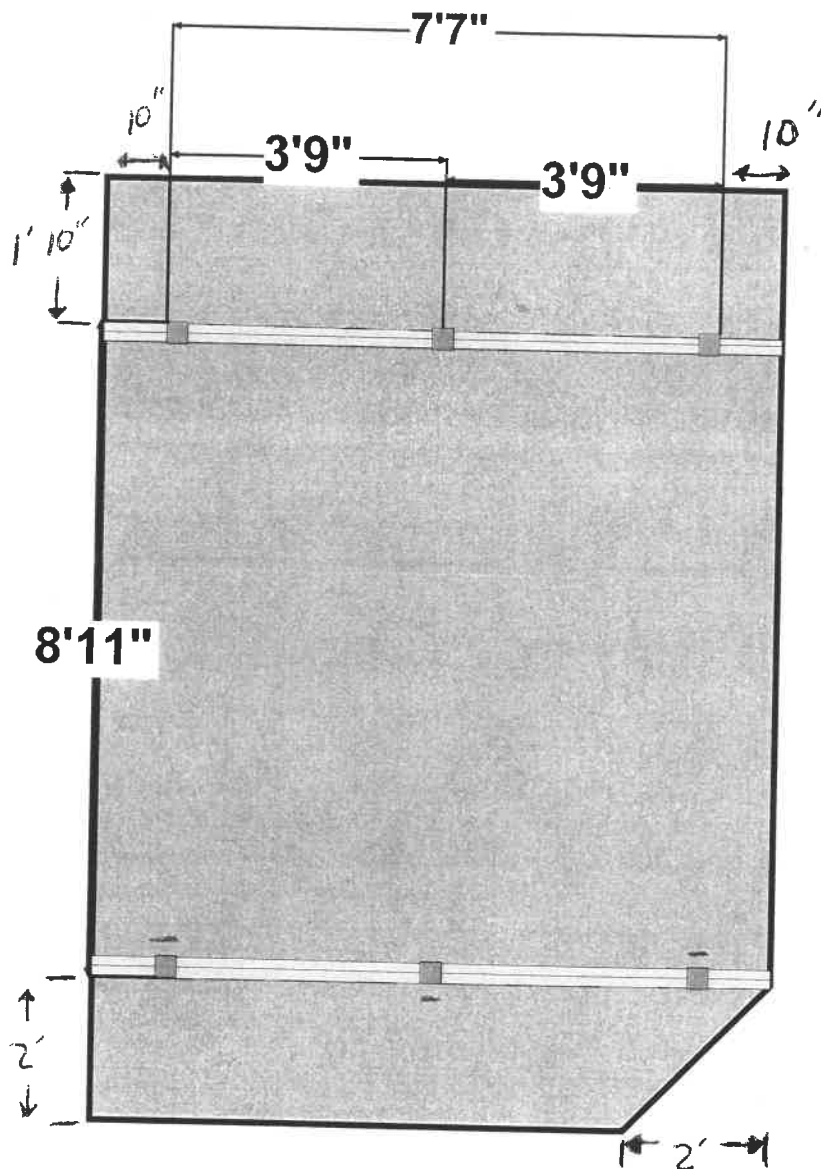

Layout dimension sheets are intended as a construction aid. Not all options selected are shown.

Final design should be performed by a registered professional engineer to ensure all applicable building codes and regulations are met.

This is an estimate. It is only for general price information. This is not an offer and there can be no legally binding contract between the parties based on this estimate. The prices stated herein are subject to change depending upon the market conditions. The prices stated on this estimate are not firm for any time period unless specifically written otherwise on this form. The availability of materials is subject to inventory conditions. MENARDS IS NOT RESPONSIBLE FOR ANY LOSS INCURRED BY THE GUEST WHO RELIES ON PRICES SET FORTH HEREIN OR ON THE AVAILABILITY OF ANY MATERIALS STATED HEREIN. All information on this form, other than price, has been provided by the guest and Menards is not responsible for any errors in the information on this estimate, including but not limited to quantity, dimension and quality. Please examine this estimate carefully. MENARDS MAKES NO REPRESENTATIONS, ORAL, WRITTEN OR OTHERWISE THAT THE MATERIALS LISTED ARE SUITABLE FOR ANY PURPOSE BEING CONSIDERED BY THE GUEST. BECAUSE OF THE WIDE VARIATIONS IN CODES, THERE ARE NO REPRESENTATIONS THAT THE MATERIALS LISTED HEREIN MEET YOUR CODE REQUIREMENTS.

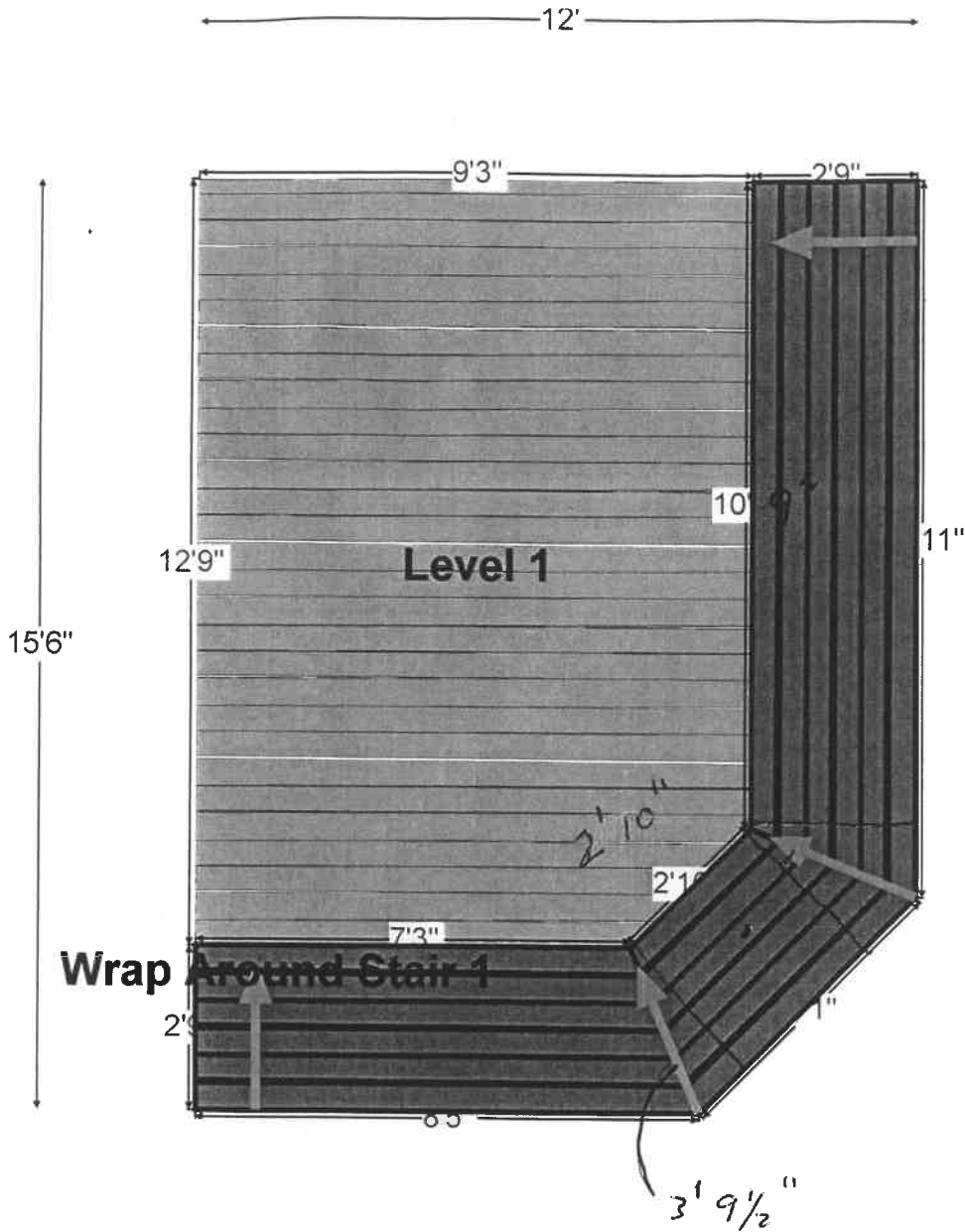

Estimated Price:

\$2,592.12*

*Today's estimated price, future pricing may go up or down. Tax, labor, and delivery not included.

Base Price:

\$2,598.71**

**The base price includes: 40 PSF deck live load, AC2 5/4x6 deck boards in horizontal direction, AC2 4x4 framing posts, precast concrete (1 bag) footing, AC2 joists and beams with two feet cantilever, galvanized framing fasteners and joists hangers, and premium deck board screws.

Final design should be performed by a registered professional engineer to ensure all applicable building codes and regulations are met.

Joist Layout for Level 1

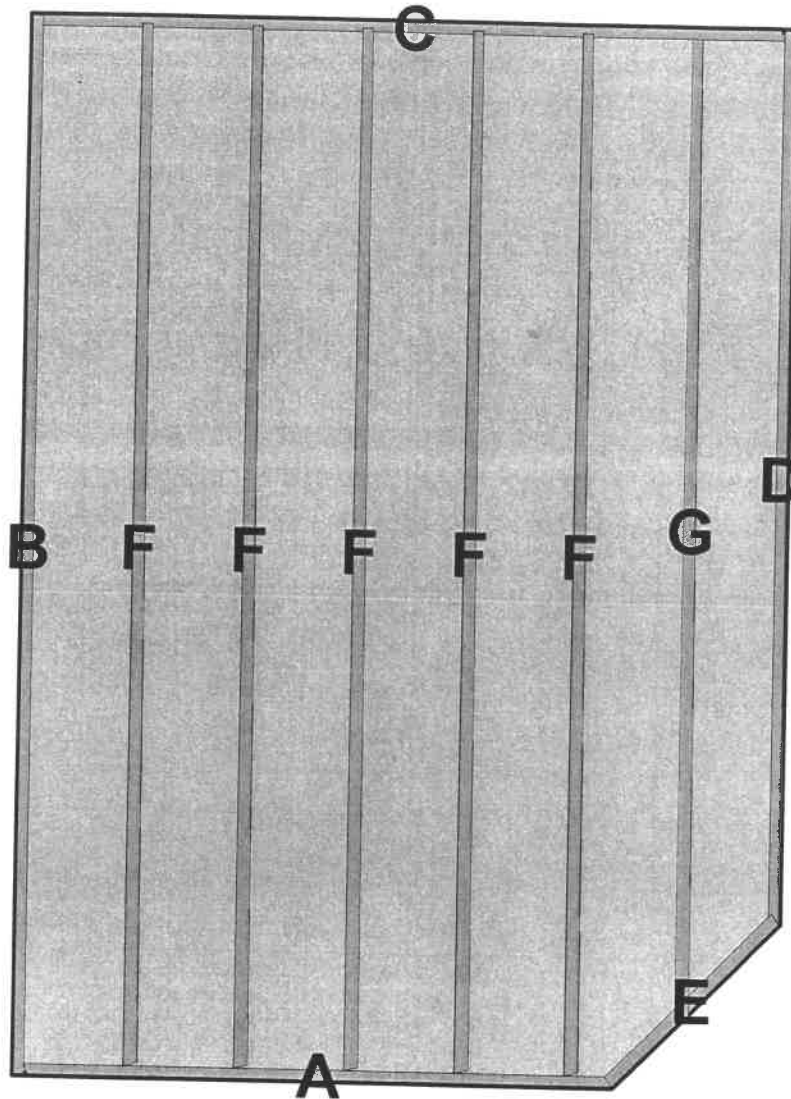

Mark	Length	Description	Usage
A	7' 2"	1-2X8 AC2	Rim Joist
B	12' 9"	1-2X8 AC2	Rim Joist
C	9' 0"	1-2X8 AC2	Rim Joist
D	10' 9"	1-2X8 AC2	Rim Joist
E	2' 10"	1-2X8 AC2	Rim Joist
F	12' 7"	5-2X8 AC2	Rim Joist
G	11' 10"	1-2X8 AC2	Internal Joist

Joist to be on 16 "

Joist to be toe-nailed to beams with 3-1/2" fasteners

Rim Joists to be faced-nailed to joist and ledgers with 3-1/2" fasteners

Y bracing is estimated, but not shown. Blocking and bridging may be required by your local code

Layout dimension sheets are intended as a construction aid. Not all options selected are shown.